

## EV and ICE Car Fire Blanket

The most efficient way to isolate and extinguish car fires, even in electric vehicles.

Any car fire is dangerous and toxic. A car fire in a gas station, road tunnel, car park or passenger ferry can be a disaster. The Car Fire Blanket enables you to contain the flames, smoke and toxic fumes in a car fire in seconds and extinguish it in minutes. It's the only solution that can effectively handle fires in electric cars.



### SPECIFICATION

Darco Code	DCFB7X10SE	DCFB6X9SS
Sizes	7mx10m	6mx9m
Weights	41Kg	44kg
Material	High temperature resistant fire-proof <b>silicone coated fibreglass</b>	<b>Silicone Coated Silica/Quartz</b> EV Blanket Premium higher temperature rated and reusable.
Smartbag	Waterproof bag, carried as a backpack or a bag for easy portability	
Car Size	Handles normal size vehicles up to SUVs such as Land Rovers, XC90 etc.	
Application	The fire and smoke are isolated within seconds of spreading the blanket over the car. Ideal solution for parking garages, shopping centres, hospitals, hotels, boat ferries, car dealerships, metropolitan areas, etc.	

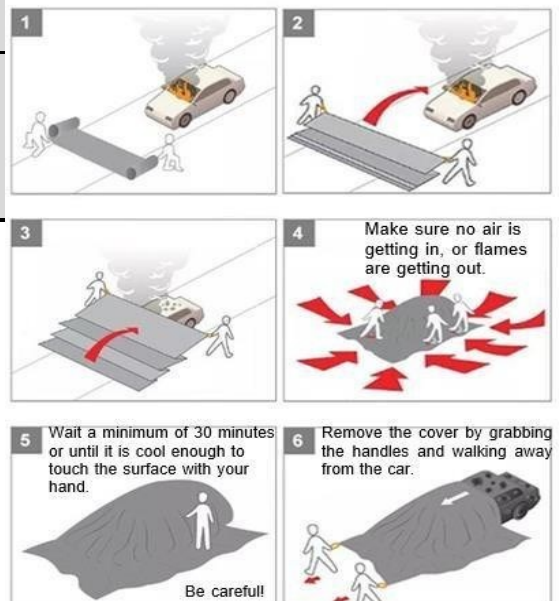

### DIRECTIONS

1. Unroll the blanket in front of or behind the car/ burning object
2. Grab the handles in the corners, and pull over the blanket in one movement
3. Wrap the blanket tightly around the car to reduce the supply of oxygen
4. Fire is contained stopping the spread of smoke and fire

## Car Fire Blanket

EV Car Fire Blankets are usually made using Silicone coated glass fabrics designed to take high temperatures and cut off the air to the fire to smother off the flames.

**Standard Quality: EV Car Fire Blanket Fabric: Designed to be used once only.**

Grey silicone coated E glass fiberglass fabric 590 g/m<sup>2</sup>, rated to 1000°C for a few minutes.

Note: Butane torch flame test scorches the grey silicone and the base fabric before brittle so easily breaks down. Lasts only long enough to smother out the flames.

**Best Quality: EV Car Fire Blanket Fabric: Can be reused up to 30 times according to one manufacturer. Only nom 50% more expensive than “Standard Quality”.**

Grey silicone coated high silica quartz fabric 800 g/m<sup>2</sup>, rated to 1000°C continuous and 1371°C for 15 minutes.

Note: Butane torch flame test scorches the grey silicone but the silica quartz base fabric remains strong and flexible.

**See samples enclosed. Spot the difference!**

Sales Brochure File: EV Car Fire Blankets Best and Standard Qualities

